

ES.1

- R.V. est. e int. col metodo sintetico
- Diagrammi T e M quotati

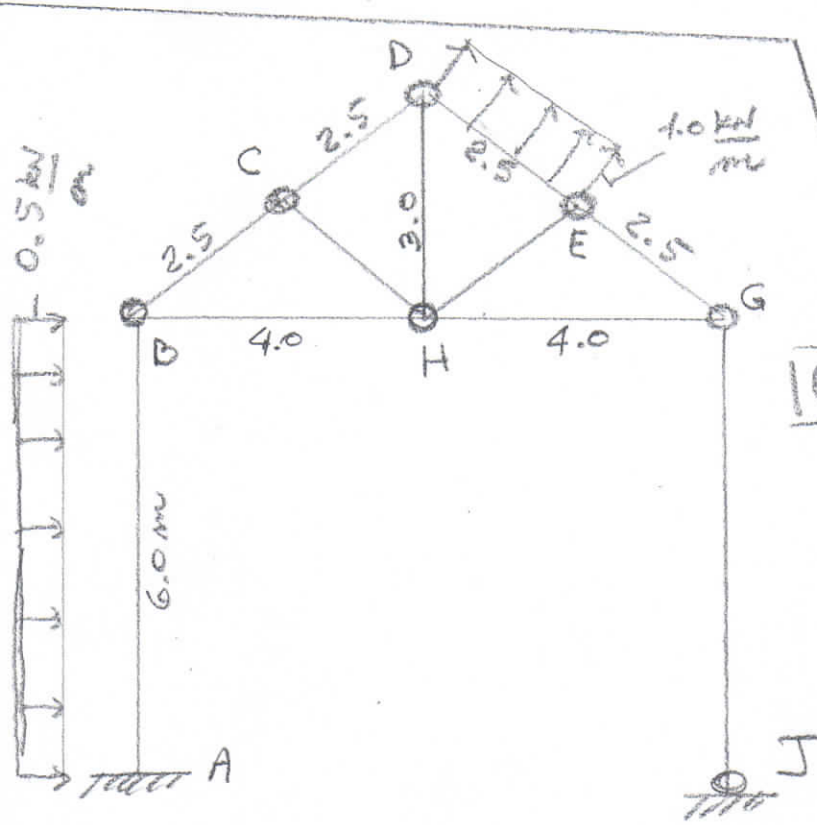

ES.2

- R.V. est (in A e J)
- R.V. int. (in B e G)
- Equilibrio di 2 nodi della capriata (e N in almeno 4 aste)

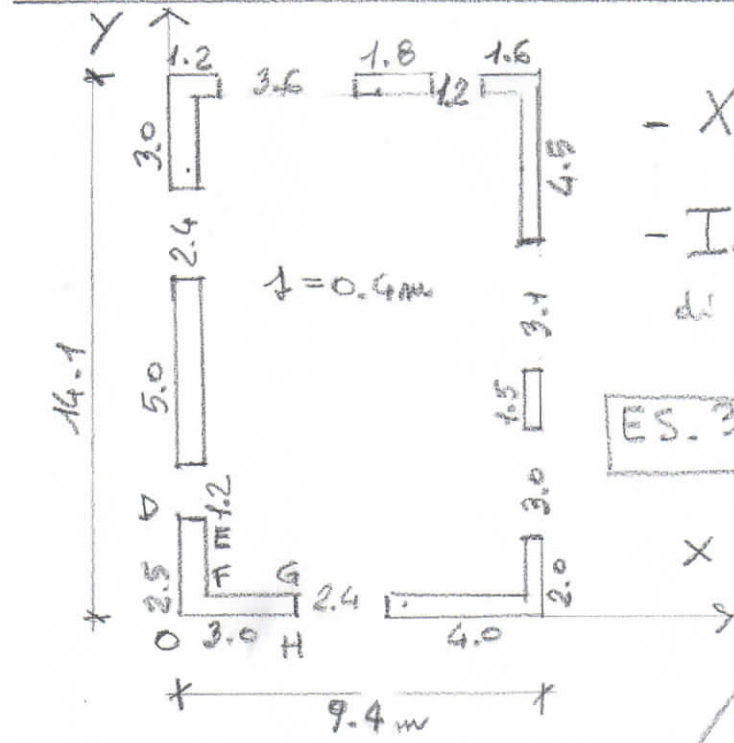

- X_G, Y_G
- I_{x_G}, I_{y_G} di ODEFGH

ES.3

- T, M dove $\neq 0$
- Spostamento di G ($E = 20000 \frac{N}{mm^2}$, $A = 10 cm^2$)

PROFILO OMEGA 30x60x40

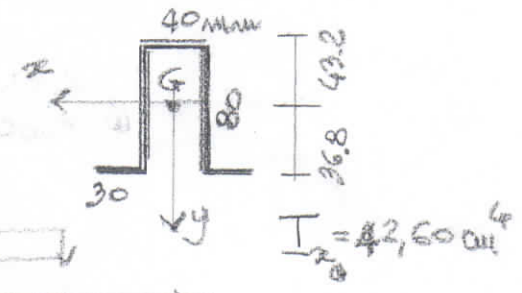

ES.4

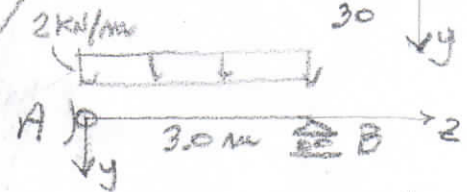

- Valore di M_{max} trave AB
- Diagramma σ_z con $M = M_{max}$
- Valori di σ_{max} a trazione e compress.