

ES.1

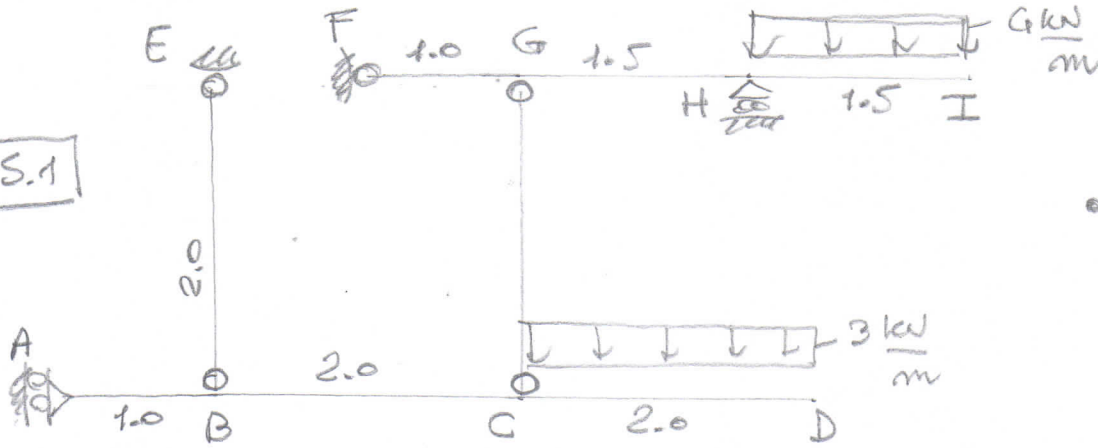

- R.V. ext (A, E, F, H) e int. (B, C, G) col metodo sintetico.

• Diagrammi N, T, M quotati

ES.2

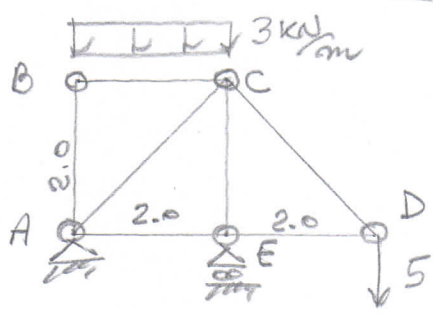

- R.V. ext (A, E)
- T e M quotati su BC
- N in almeno 4 aste
- N sulle rimanenti aste

ES.3

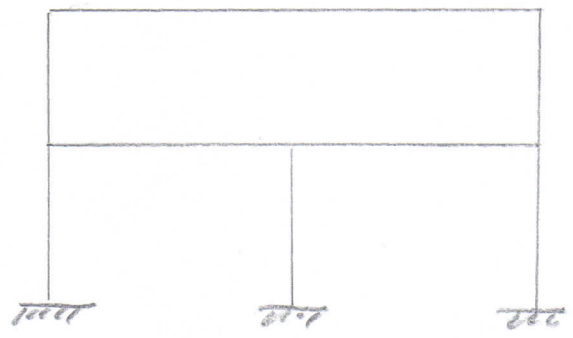

- Riclassificare le strutture
- Renderle statiche senza eliminare tratti

ES.4

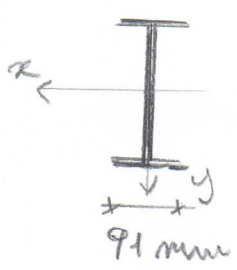
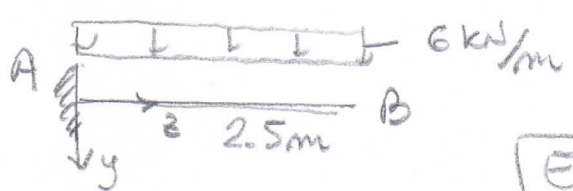

IPE 180
 $A = 23.95 \text{ cm}^2$
 $I_x = 1317 \text{ cm}^4$
 $I_y = 100.9 \text{ cm}^4$

- R.V. in A
- Diagramme σ_z (σ, m, m, M_A)
- Valore di σ_z^{\max}
- Un punto del nocciolo centrale d'inerzia